

Underfloor heating "MULTIBETON Screed Flat System"

The system for your new building
or your renovation

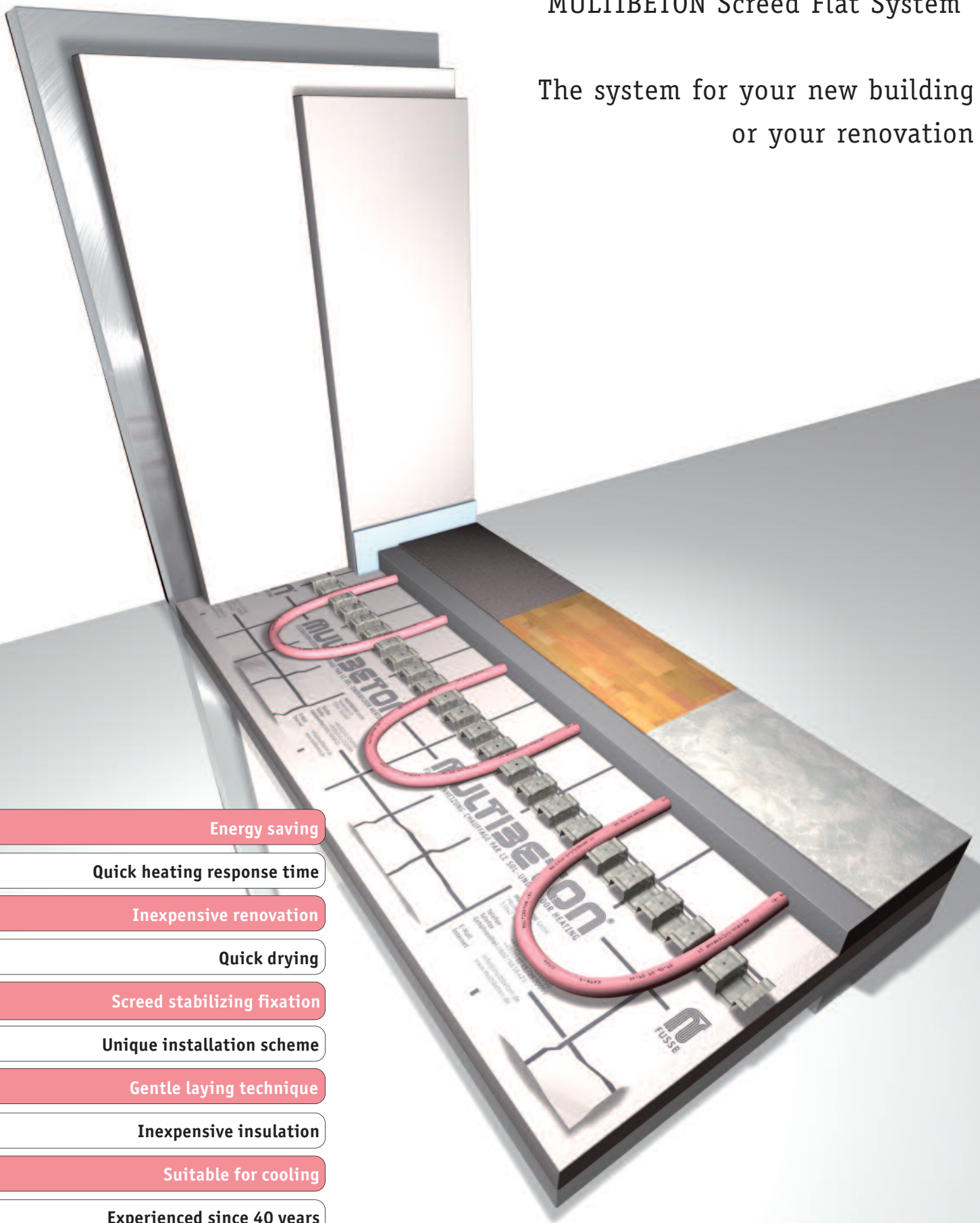

Energy saving

Quick heating response time

Inexpensive renovation

Quick drying

Screed stabilizing fixation

Unique installation scheme

Gentle laying technique

Inexpensive insulation

Suitable for cooling

Experienced since 40 years

Good value purchase

Approved installers

Exceeds quality standards

MULTIBETON
FUSSBODENHEIZUNG - CHAUFFAGE PAR LE SOL - UNDERFLOOR HEATING

MB Screed Flat System *New building, low structure*

Construction and system description

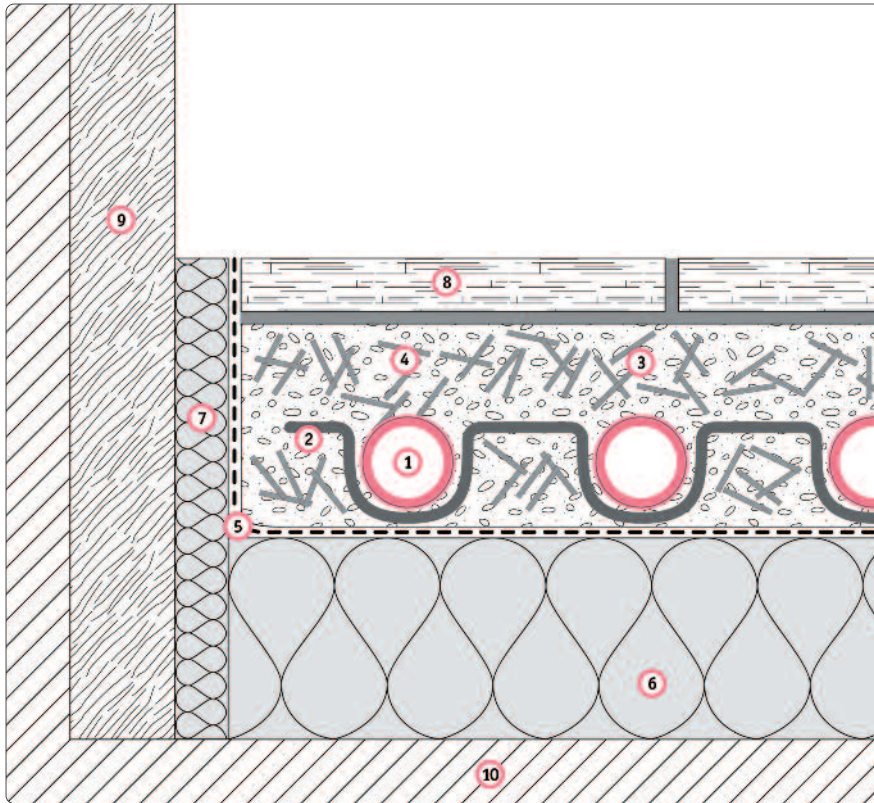

System components

01. MB Euro Systempipe 12 or 17
02. MB Steel Clipsrail 12 or 17
03. MB special heat screed
04. Special steel fibres
05. MB PE foil 0.2 mm
06. Insulation in accordance with the valid EnEV or DIN/EN
07. Edge insulation band (minimum thickness 10 mm)
08. Surface floorcovering
09. Wall plaster
10. Rough brickwork

Applications

The MB Screed Flat System is designed to be of minimum thickness with a quick drying time.

Technical data	MB Euro Systempipe 12	MB Euro Systempipe 17
Construction height	at least 40 mm	at least 40 mm
Pipe cover	28 mm	23 mm
Construction mass	about 70 kg/m ²	about 70 kg/m ²
Load capacity	2.0 kN/m ²	2.0 kN/m ²

Higher load capacity

In order to increase these loads, e.g. up to 3.5 kN/m², a construction height of 50 mm is recommended.