

Underfloor heating *Dry construction*
"MULTIBETON Ready Floor S"

The system for your renovation

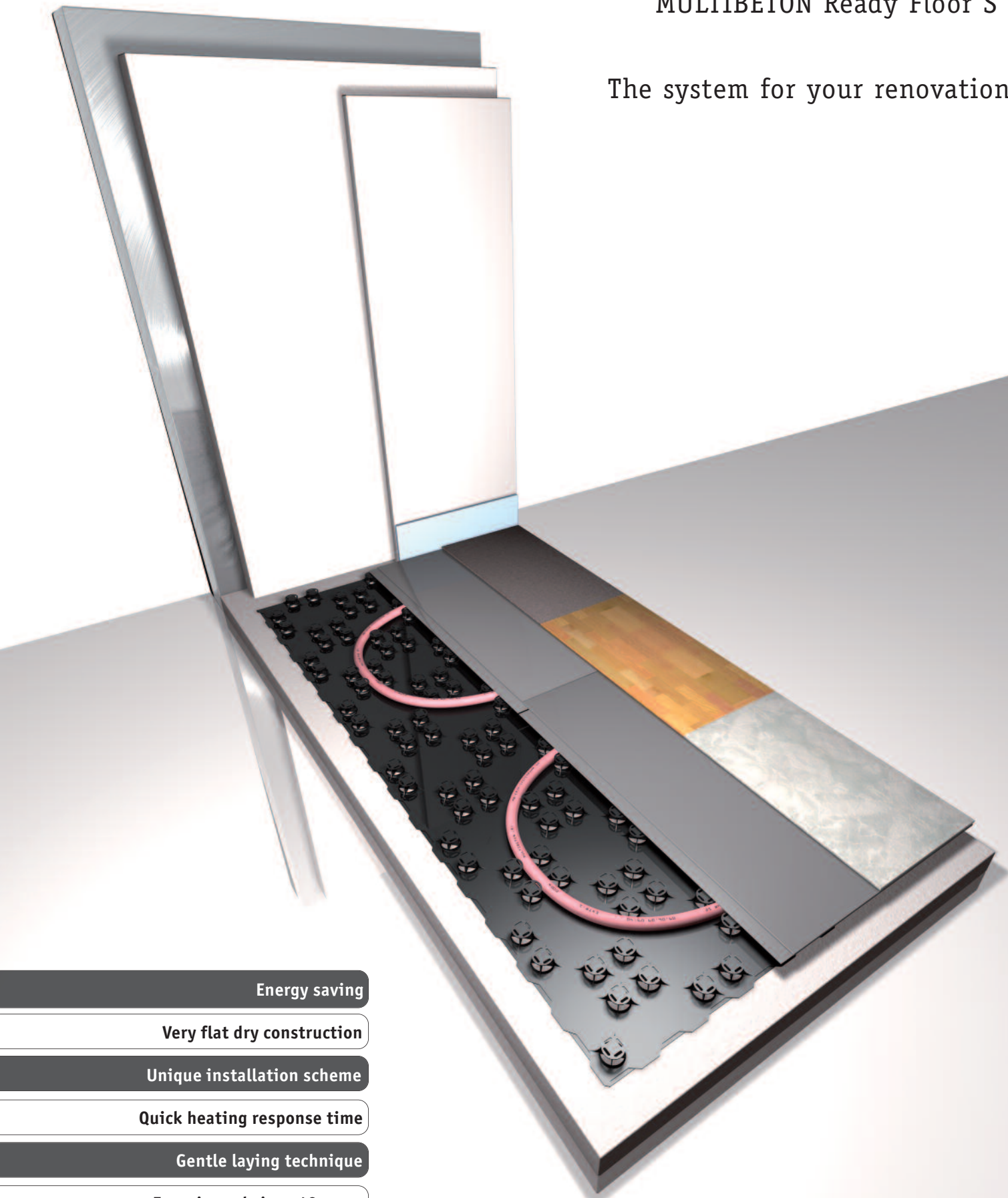

Energy saving

Very flat dry construction

Unique installation scheme

Quick heating response time

Gentle laying technique

Experienced since 40 years

Inexpensive insulation

Approved installers

Exceeds quality standards

MULTIBETON
FUSSBODENHEIZUNG - CHAUFFAGE PAR LE SOL - UNDERFLOOR HEATING

MB Ready Floor New and old building, dry, low, lightweight

Construction and system description

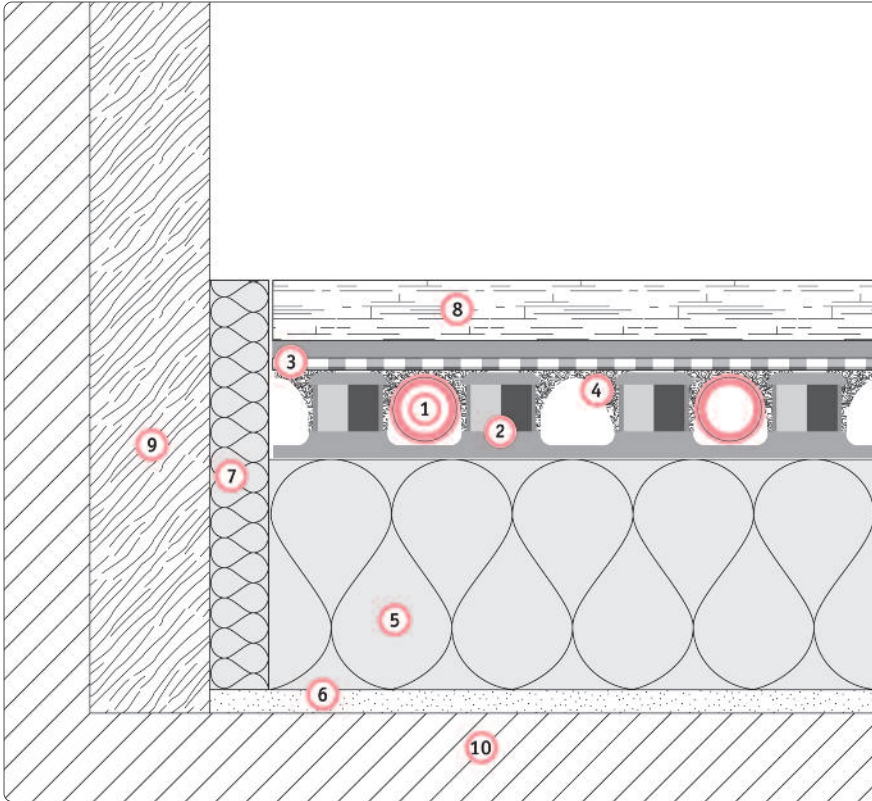

System components

MB Ready Floor S

01. MB Euro Systempipe 12
02. MB Baseplate
03. MB Steel Tiles
04. MB Contact Adhesive
05. Additional layer of insulation (if necessary); rigid, solid insulation board, not more than 40 mm thick
06. Equalizing layer (if necessary)
07. Edge insulation band (10 mm minimum thickness)
08. Surface floorcovering
09. Wall plaster
10. Rough brickwork

Applications

The MB Ready Floor S system has been specially developed for buildings where a thin and lightweight system is required. It can heat up and cool down very quickly. It is ideal for use in the refurbishment of existing houses, commercial buildings and in other installations where the thinnest possible system and rapid heating response times are required.

Technical data

Construction height	ca. 19 mm
Construction mass	ca. 20 kg/m ²
Load capacity	2.0 kN/m ²
Loading	after 12 hours
Laying	after 12 hours
Heating-up	rapid
Operating temperature	extremely low